

# Easy-On FFC/FPC Connectors, 0.50/1.00mm Pitch, Slider Series

**molex**

The Easy-On FFC/FPC Connectors, 0.50/1.00mm Pitch, Slider Series, with their market proven 'Slider' locking mechanism and wide circuit options in top, bottom and vertical contact variations, offer design flexibility for FFC/FPC cable routing applications

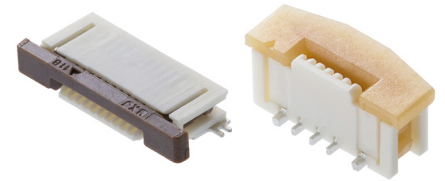

Right-Angle

Vertical

## Features and Advantages

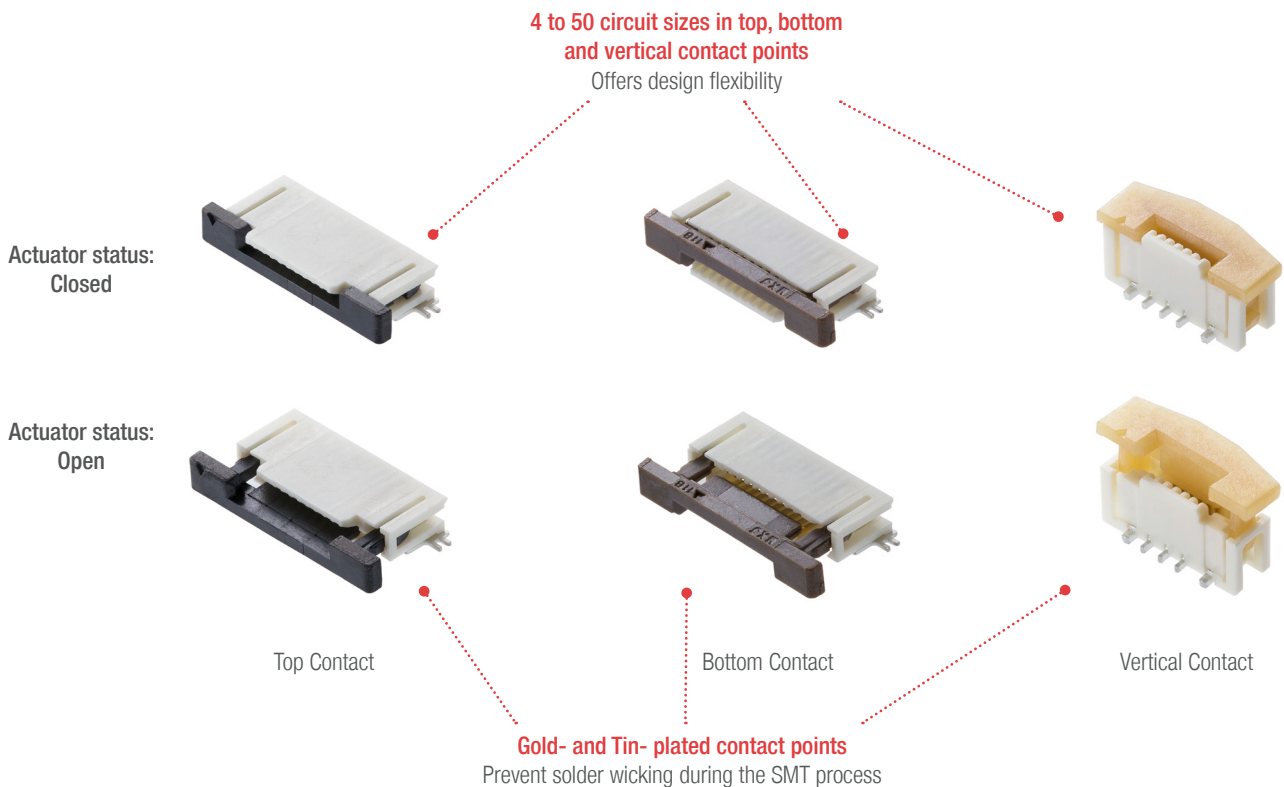

## Applications

### Industry

- IoT interconnection devices
- Smart speakers
- UAVs (Drones)
- FA robots
- Security cameras

### Mobile

- POS terminals

### Consumers

- Home appliances

### Medical

- Patient monitoring
- MRI/CT machines
- Disposable inspection devices



POS terminal



Medical

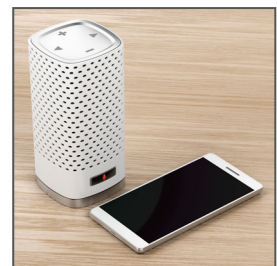

IoT device

# Easy-On FFC/FPC Connectors, 0.50/1.00mm Pitch, Slider Series



## Specifications

### REFERENCE INFORMATION

Packaging: Embossed Tape and Reel  
Use With: FFC/FPC  
Designed In: Millimeters  
RoHS: Yes

### ELECTRICAL

Voltage (max.): 50V  
Current (max.): 0.5A per circuit  
Contact Resistance (max.): 20 milliohms  
Dielectric Withstanding Voltage: 250V AC  
Insulation Resistance (min.): 50 Megohms

### MECHANICAL

FFC/FPC Thickness: 0.30mm  
Durability (max.): 20 cycles

### PHYSICAL

Housing: LCP, UL 94V-0  
Actuator: PA, UL 94V-0  
Contact: Copper Alloy  
Plating:  
Contact Area — Gold or New Tin  
Solder Tail Area — Gold or New Tin  
Underplating — Nickel  
Fitting Nail: Copper Alloy, Tin over Nickel plating  
Operating Temperature: -40 to +85°C

### CIRCUIT SIZES

4, 5, 6, 7, 8, 9, 10, 11, 12, 13, 14, 15, 16, 17, 18,  
19, 20, 21, 22, 23, 24, 25, 26, 27, 28, 29, 30, 31,  
32, 33, 34, 35, 36, 37, 38, 39, 40, 41, 42, 43, 44,  
45, 50

## Dimensions

Refer to molex.com for detail dimension

## Ordering Information

Series No.	Pitch (mm)	Orientation	Contact Position	Circuits	Operating Temperature	Plating
52745- <b>**33</b>	0.50	Right-Angle	Top	4 to 20	-40 to +85°C	New Tin
52745- <b>**97</b>	0.50	Right-Angle	Top	4 to 20	-40 to +85°C	Gold
52746- <b>**33</b>	0.50	Right-Angle	Bottom	4 to 20	-40 to +85°C	New Tin
52746- <b>**71</b>	0.50	Right-Angle	Bottom	4 to 20	-40 to +85°C	Gold
52435- <b>**33</b>	0.50	Right-Angle	Top	21 to 30	-40 to +85°C	New Tin
52435- <b>**71</b>	0.50	Right-Angle	Top	21 to 30	-40 to +85°C	Gold
52437- <b>**33</b>	0.50	Right-Angle	Bottom	21 to 30	-40 to +85°C	New Tin
52437- <b>**71</b>	0.50	Right-Angle	Bottom	21 to 30	-40 to +85°C	Gold
54104- <b>**33</b>	0.50	Right-Angle	Top	30 to 50	-40 to +85°C	New Tin
54104- <b>**31</b>	0.50	Right-Angle	Top	30 to 50	-40 to +85°C	Gold
54132- <b>**33</b>	0.50	Right-Angle	Bottom	30 to 50	-40 to +85°C	New Tin
54132- <b>**62</b>	0.50	Right-Angle	Bottom	30 to 50	-40 to +85°C	Gold
52559- <b>**34</b>	0.50	Vertical	Vertical	6 to 42	-40 to +85°C	New Tin
52559- <b>**52</b>	0.50	Vertical	Vertical	6 to 42	-40 to +85°C	Gold
52207- <b>**33</b>	1.00	Right-Angle	Top	3 to 34	-40 to +85°C	New Tin
52207- <b>**60</b>	1.00	Right-Angle	Top	3 to 34	-40 to +85°C	Gold
52271- <b>**79</b>	1.00	Right-Angle	Bottom	4 to 30	-40 to +85°C	New Tin
52271- <b>**69</b>	1.00	Right-Angle	Bottom	4 to 30	-40 to +85°C	Gold
52610- <b>**33</b>	1.00	Vertical	Vertical	5 to 30	-40 to +85°C	New Tin
52610- <b>**72</b>	1.00	Vertical	Vertical	5 to 30	-40 to +85°C	Gold

Replace \*\* with circuit size

[www.molex.com/link/easyon.html](http://www.molex.com/link/easyon.html)