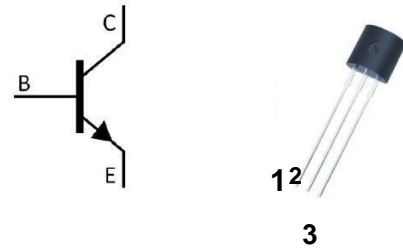

GENERAL PURPOSE TRANSISTOR

REPLACEMENT TYPE : BC337 NPN

MAXIMUM RATINGS (T_A=25°C unless otherwise noted)

PIN1: Emitter PIN 2: Base PIN 3: Collector

极限参数 / Absolute Maximum Ratings(T_a=25°C)

参数 Parameter	符号 Symbol	数值 Rating	单位 Unit
Collector to Base Voltage	V _{CB0}	50	V
Collector to Emitter Voltage	V _{CEO}	45	V
Emitter to Base Voltage	V _{EBO}	5.0	V
Collector Current - Continuous	I _C	800	mA
Emitter Current - Continuous	I _E	800	mA
Collector Power Dissipation	P _C	625	mW
Junction Temperature	T _j	150	°C
Storage Temperature Range	T _{stg}	-55~150	°C

电性能参数 / Electrical Characteristics(T_a=25°C)

参数 Parameter	符号 Symbol	测试条件 Test Conditions	最小值 Min	典型值 Typ	最大值 Max	单位 Unit
Collector Cut-Off Current	I _{CBO}	V _{CB} =45V I _E =0			0.1	μA
DC Current Gain	h _{FE}	V _{CE} =1.0V I _C =100mA	100		600	
Collector to Emitter Saturation Voltage	V _{CE(sat)}	I _C =500mA I _B =50mA			0.7	V
Base to Emitter On Voltage	V _{BE}	V _{CE} =1.0V I _C =300mA			1.2	V
Transition Frequency	f _T	V _{CE} =5.0V I _C =10mA f=100MHz		100		MHz
Collector output capacitance	C _c	V _{CB} =10V f=1.0MHz		12		pF

CLASSIFICATION OF h_{FE}

Rank	-16	-25	-40
Range	100-250	160-400	260-630

--	--	--	--

GENERAL PURPOSE TRANSISTOR

电参数曲线图 / Electrical Characteristic Curve

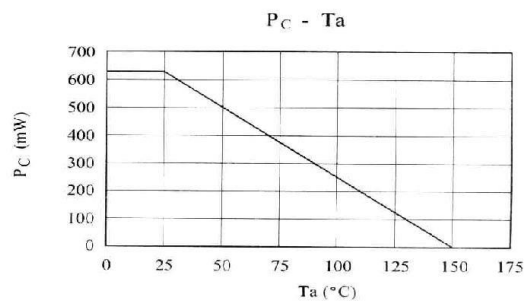
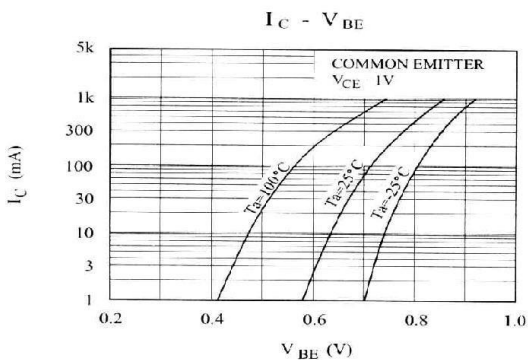
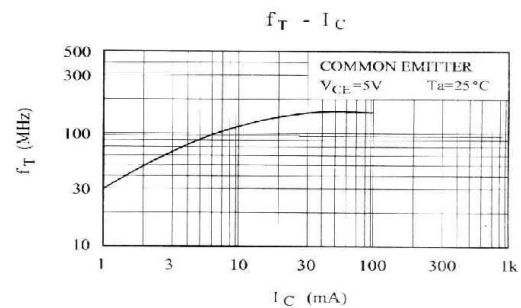
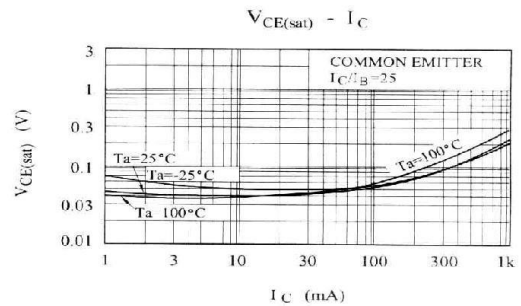
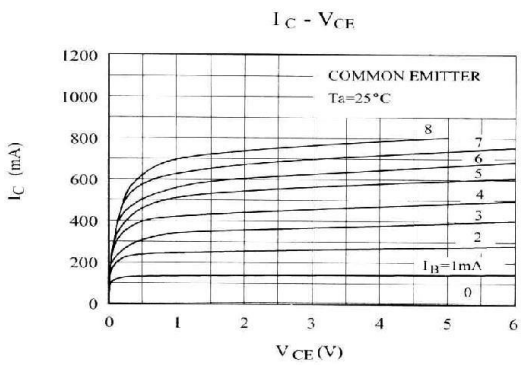
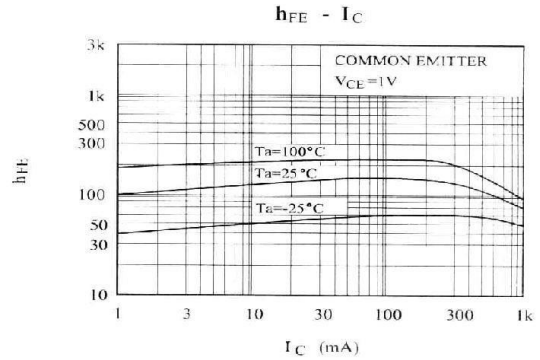
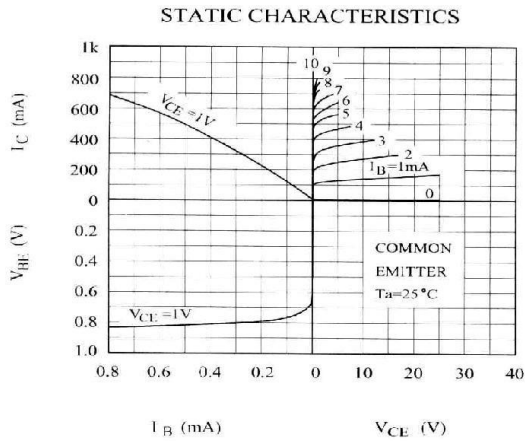

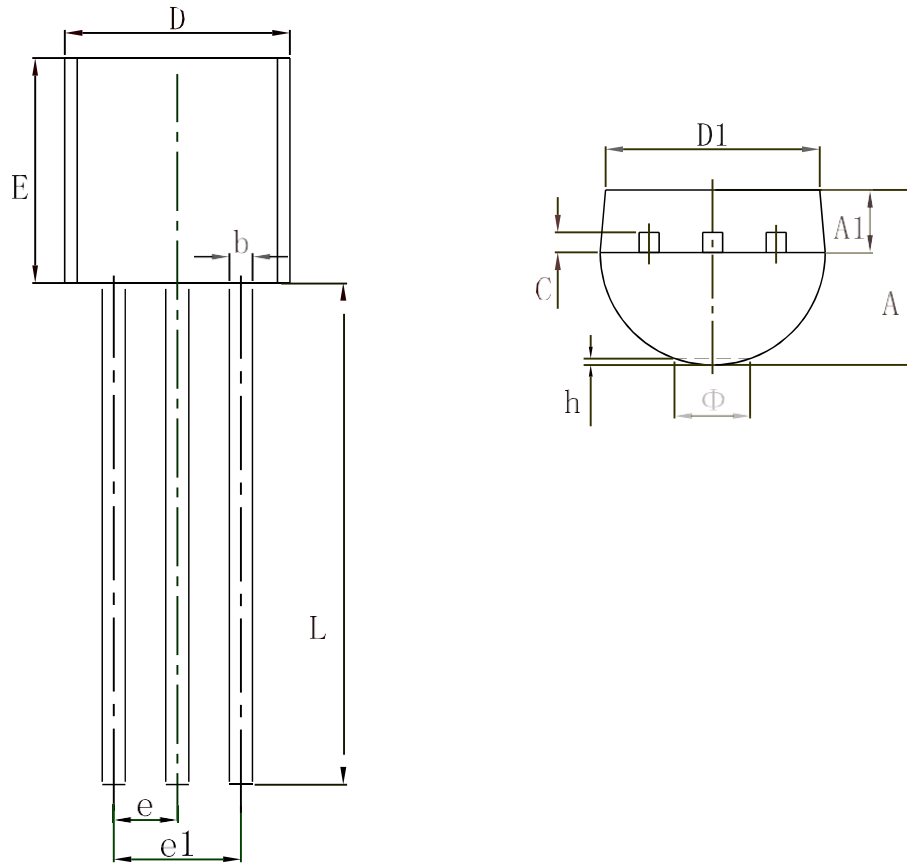
TO-92 Package Outline Dimensions

Symbol	Dimensions In Millimeters		Dimensions In Inches	
	Min.	Max.	Min.	Max.
A	3.300	3.700	0.130	0.146
A1	1.100	1.400	0.043	0.055
b	0.380	0.550	0.015	0.022
c	0.360	0.510	0.014	0.020
D	4.300	4.700	0.169	0.185
D1	3.430		0.135	
E	4.300	4.700	0.169	0.185
e	1.270 TYP.		0.050 TYP.	
e1	2.440	2.640	0.096	0.104
L	14.100	14.500	0.555	0.571
Φ		1.600		0.063
h	0.000	0.380	0.000	0.015

TO-92 Package Taping Dimension

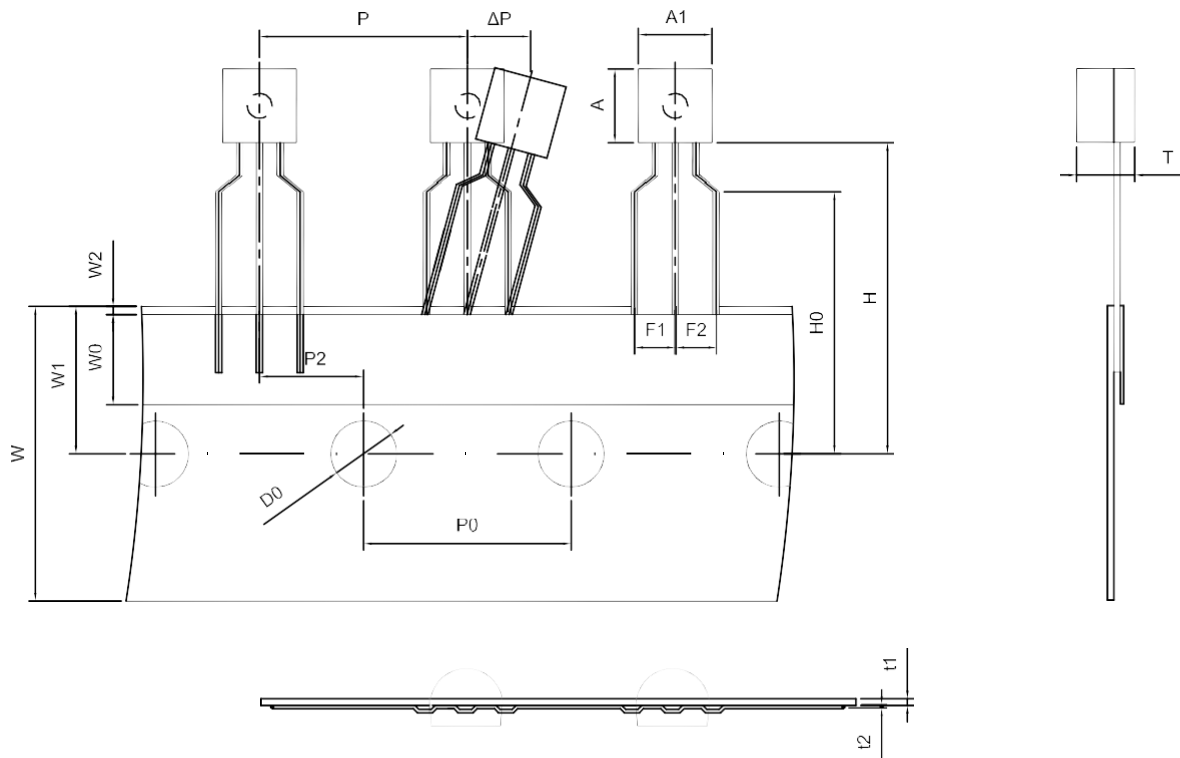

Dimensions are in millimeter								
A1	A	T	P	P0	P2	F1	F2	W
4.5±0.2	4.5±0.2	3.5±0.2	12.7±0.3	12.7±0.2	6.35±0.3	2.5±0.3	2.5±0.3	18.0+1.0/-0.5
W0	W1	W2	H	H0	D0	t1	t2	ΔP
6.0±0.5	9.0±0.5	1.0 MAX.	19.0±1.0	16.0±0.5	4.0±0.5	0.4±0.05	0.2±0.05	0 ± 1.0

